

FTOFSF-0041
FTOFSF-0045



MINI ROUND EDGE 3-DRAWER MOBILE CABINET

CONTACT US:

If you have any questions about the installation of YITAHOME products, just contact us at +1 (888) 717-8084 from Mon-Fri 8:00 AM-4:30 PM PST / Sat. 8:00 AM-12:00 PM PST or e-mail us at after-sale.cs@hotmail.com

Alternative method to contact us (amazon.com orders only)

1. Log into your Amazon account
2. Go to "Your Orders" and find the purchase
3. Click on "Contact Seller"

⚠ Attention: If you notice any fingerprints on the surface please know that they were left there during manual lifting. Simply clean the surface using a cloth and rubbing alcohol.

1. Gather and organize all required parts before assembling.
2. Assemble cabinet on a flat, clean, soft surface.
3. This filing cabinet has an anti-tipping feature to avoid falling over while in use. Only one drawer can be opened at one time and the rest must be closed.

Tools Required For Assembly

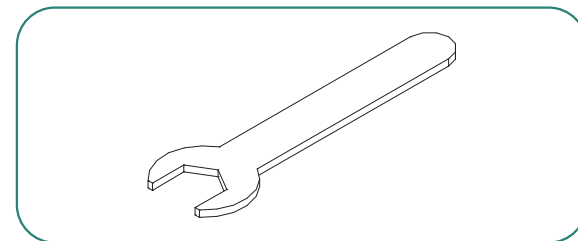

| Item no. | Reference Image | Qty. | Item no. | Reference Image | Qty. |
|----------|-----------------|------|----------|-----------------|------|
| A | | X1 | F | | X3 |
| B | | X2 | G | | X1 |
| C | | X3 | H | | X1 |
| D | | X2 | I | | X1 |
| E | | X5 | J | | X5 |

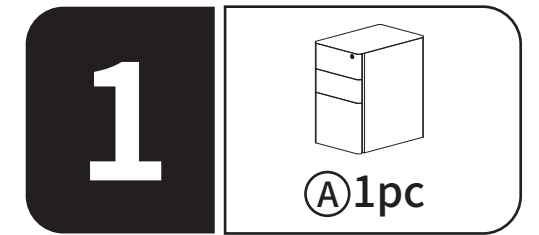
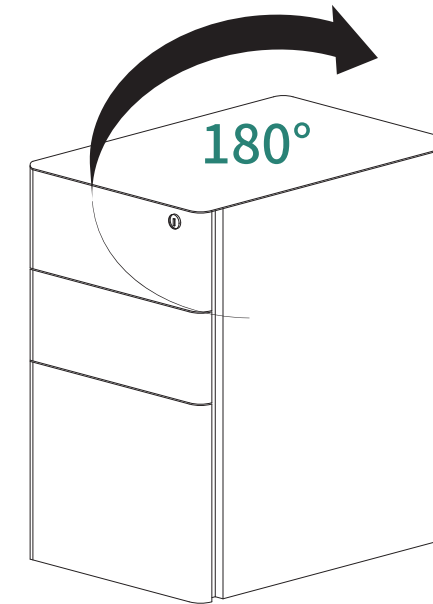

Lock the drawers before starting this step.

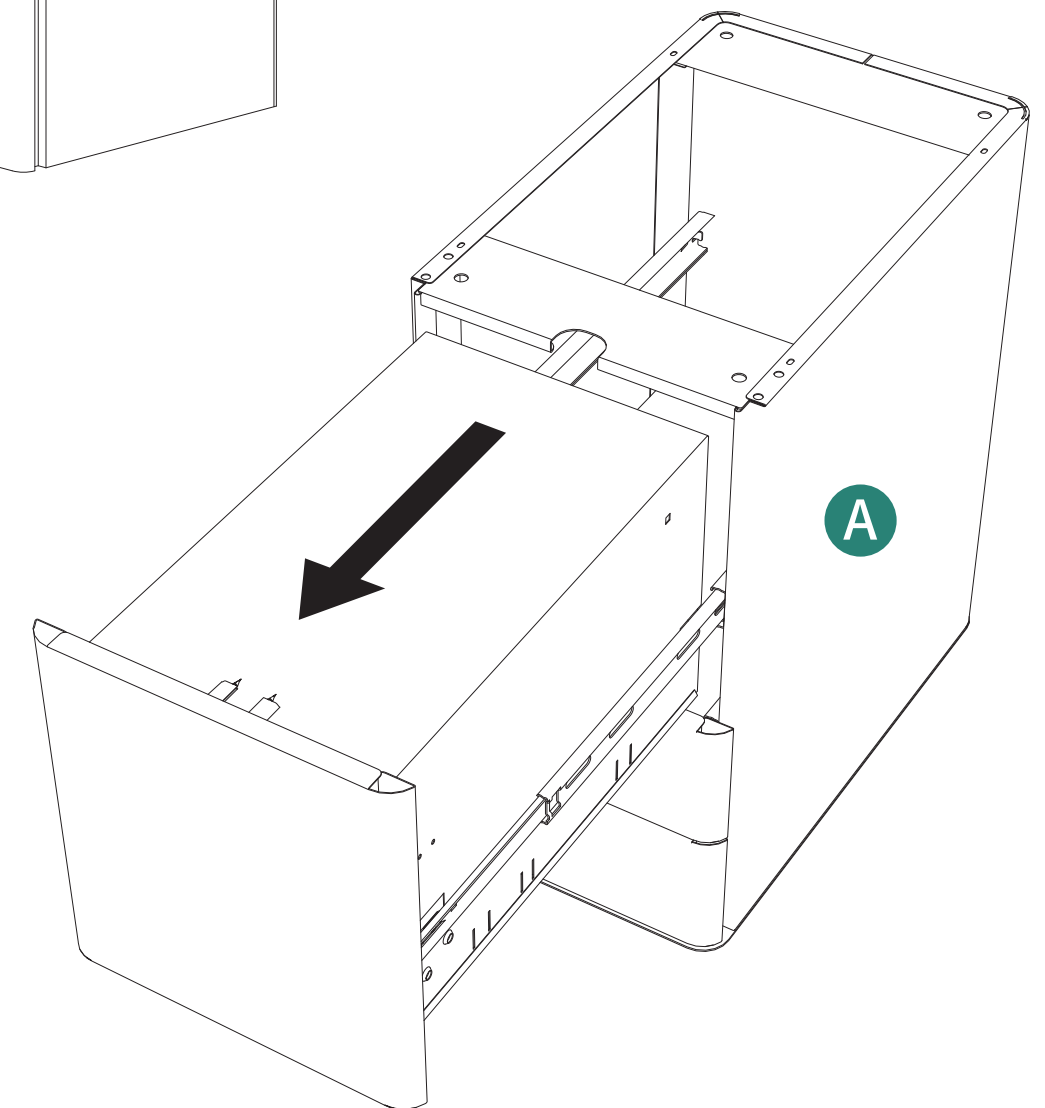

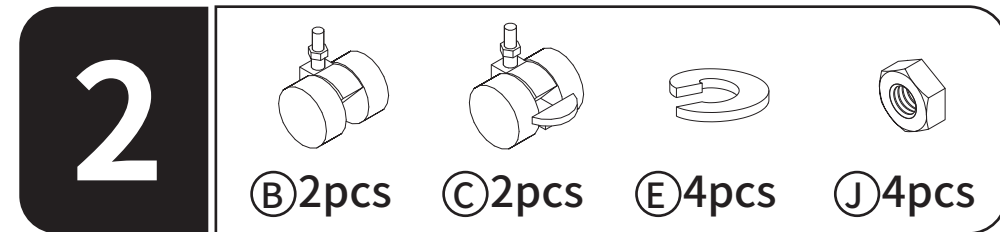

An extra caster with a brake is provided.

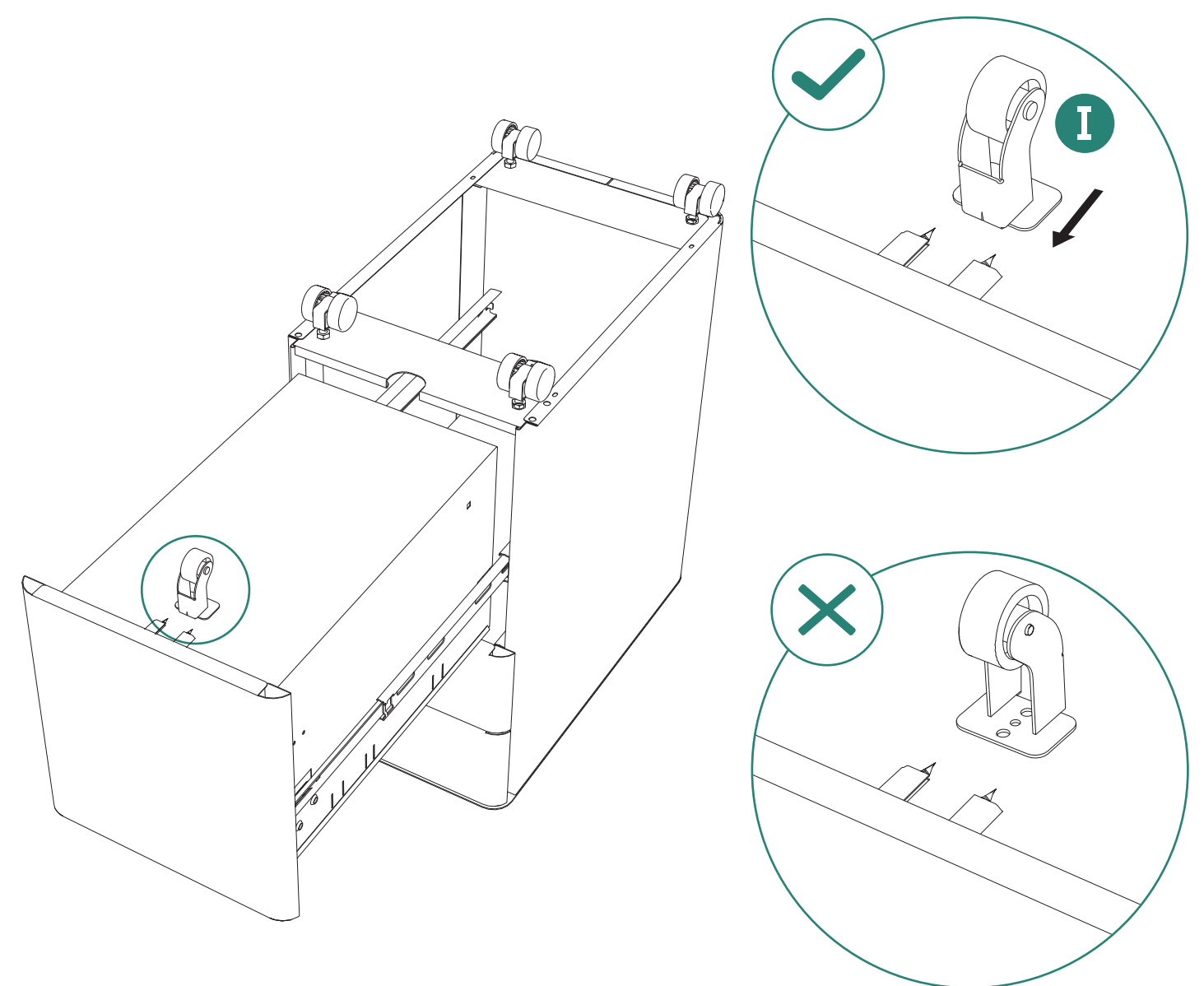
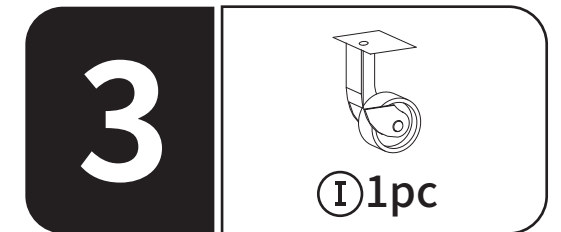
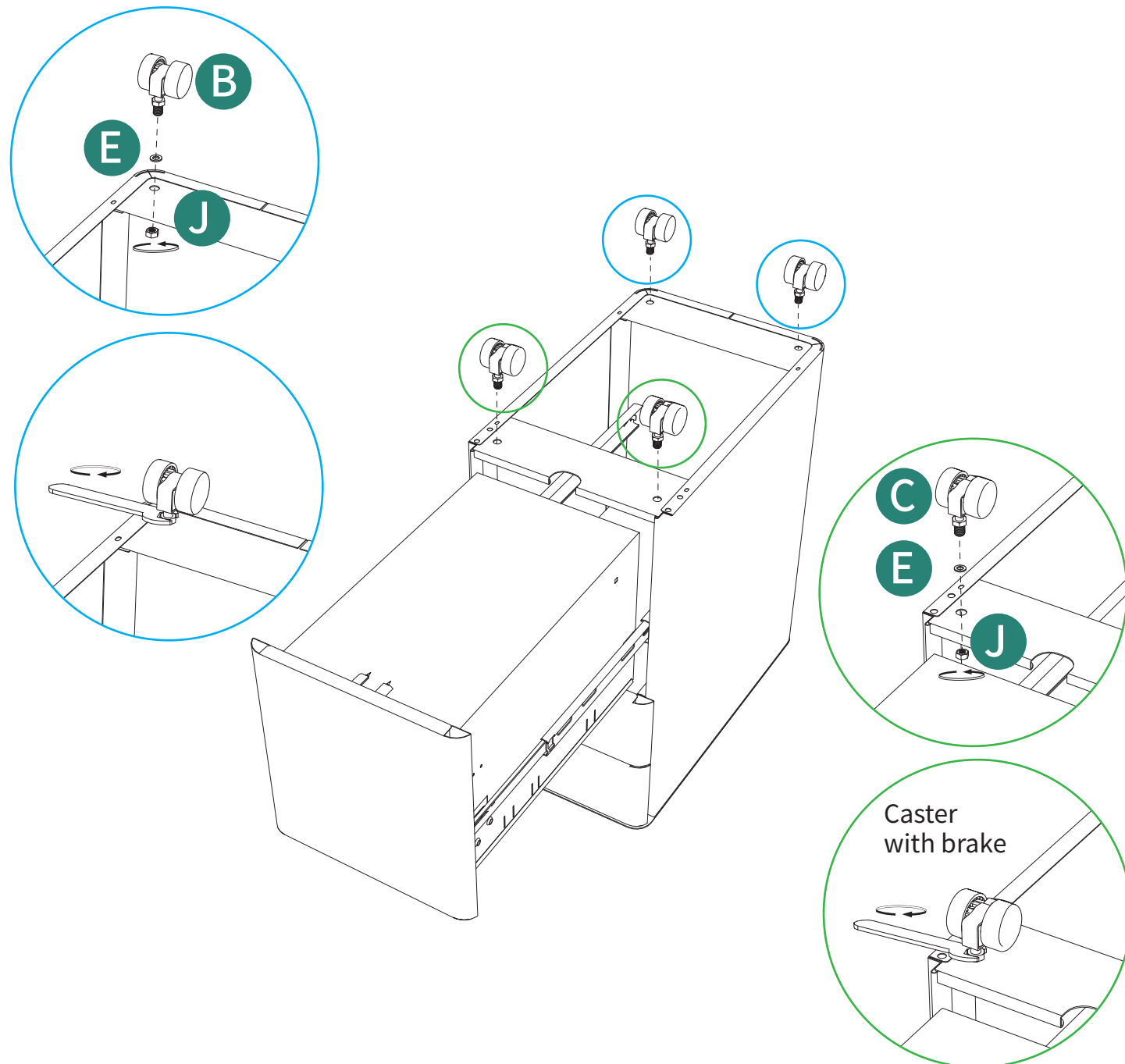

4

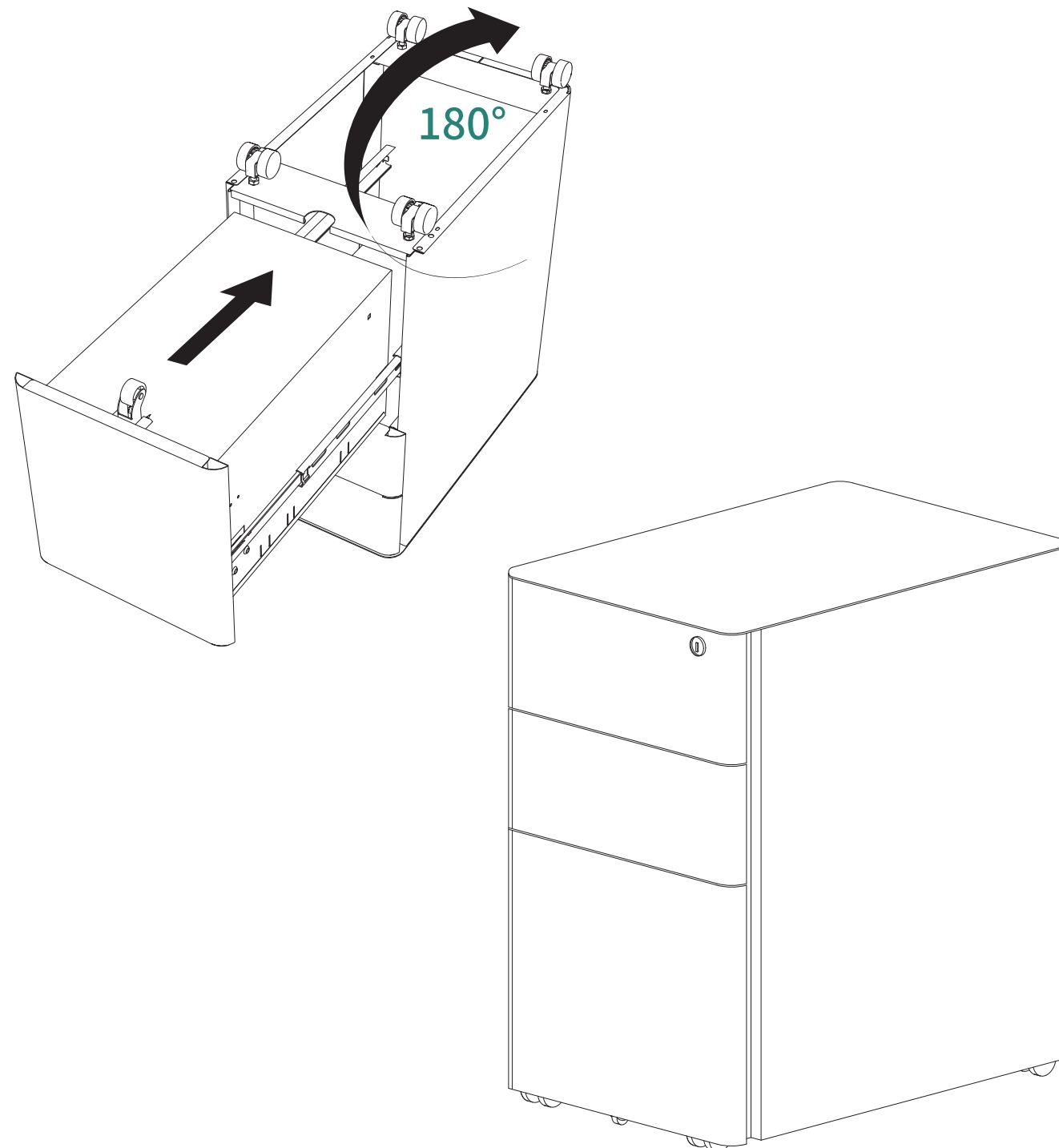

5

5

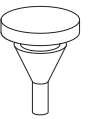

ⓕ1pc

Open the bottom drawer, install the rubber buckle, and fix the anti-tip wheel (wheel C) in place.

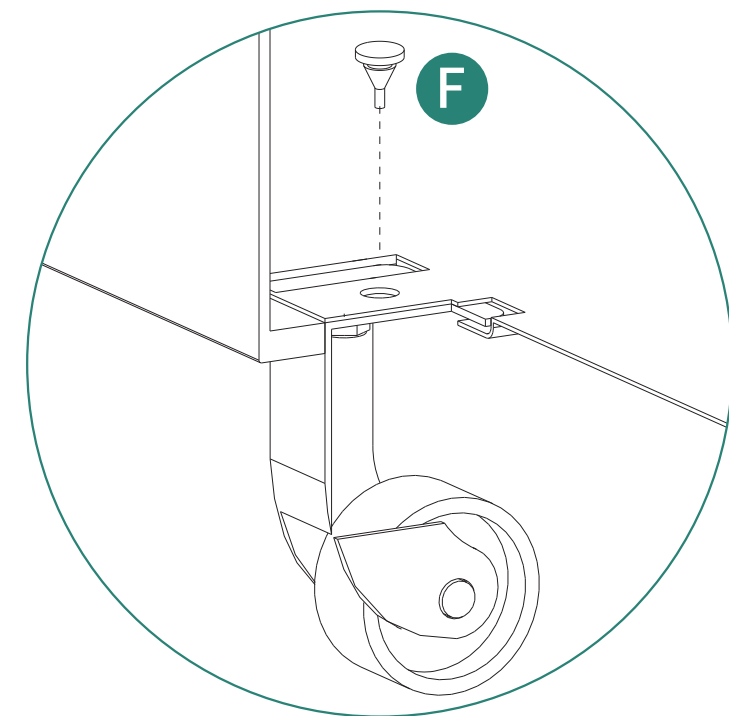
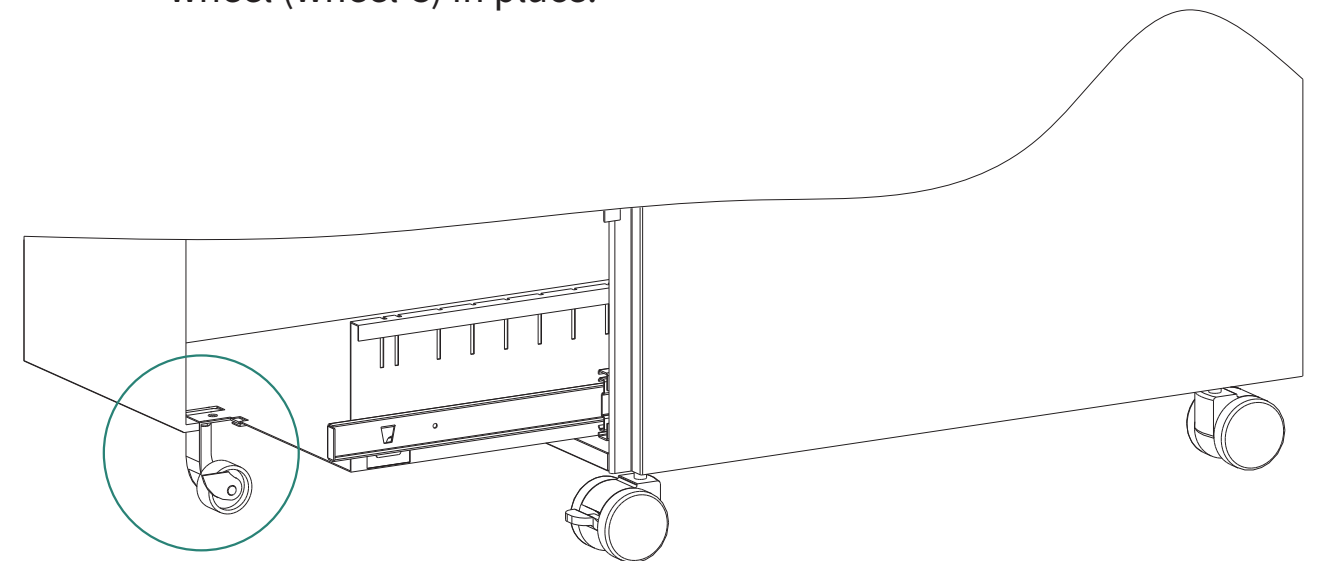

6

6

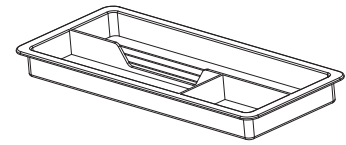

Ⓔ1pc

G

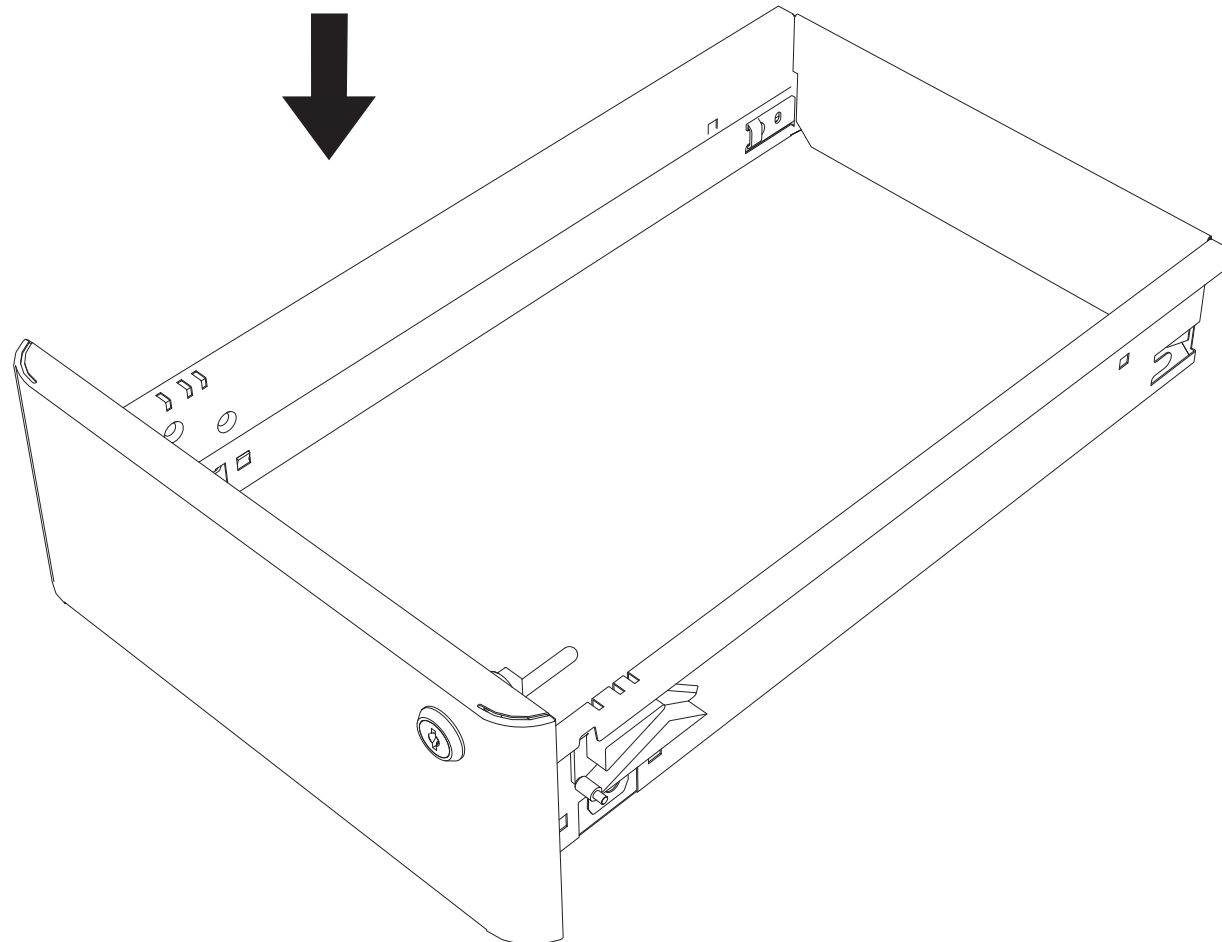
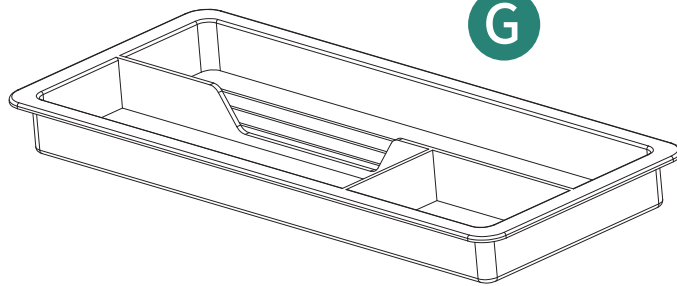

7



Ⓕ1pc

H

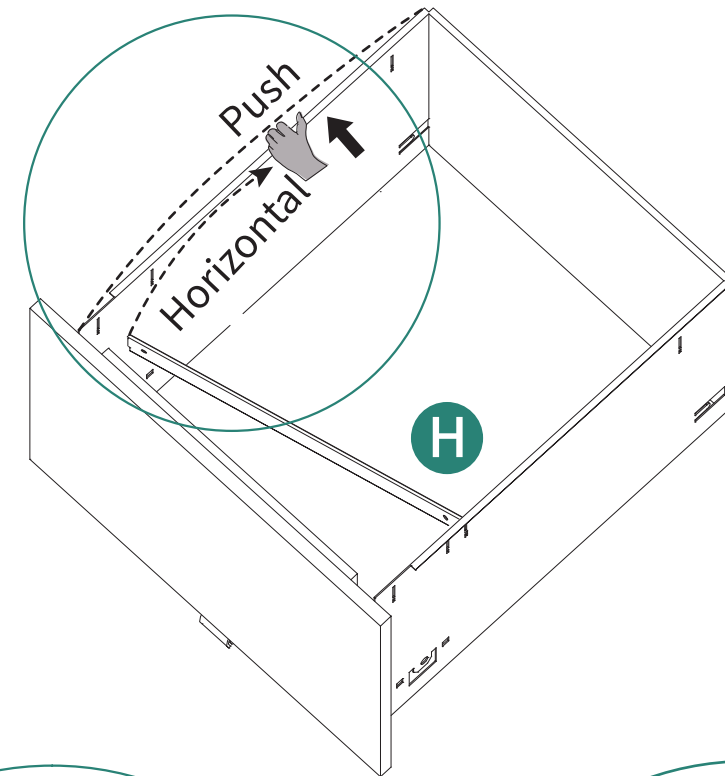

×

Vertical

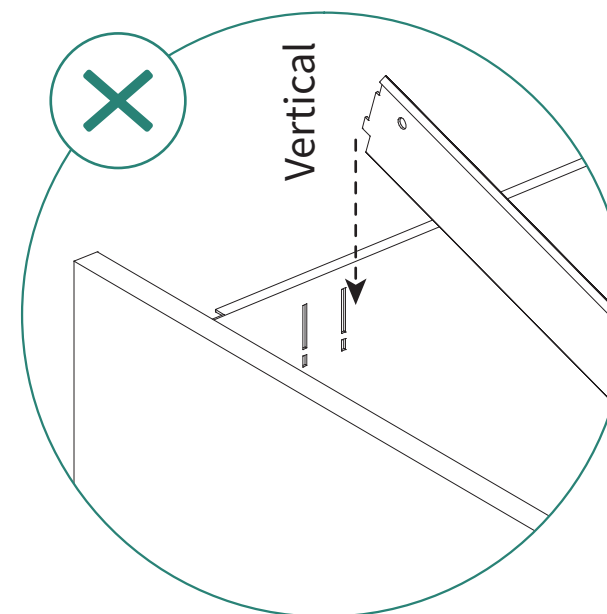

Top

Bottom

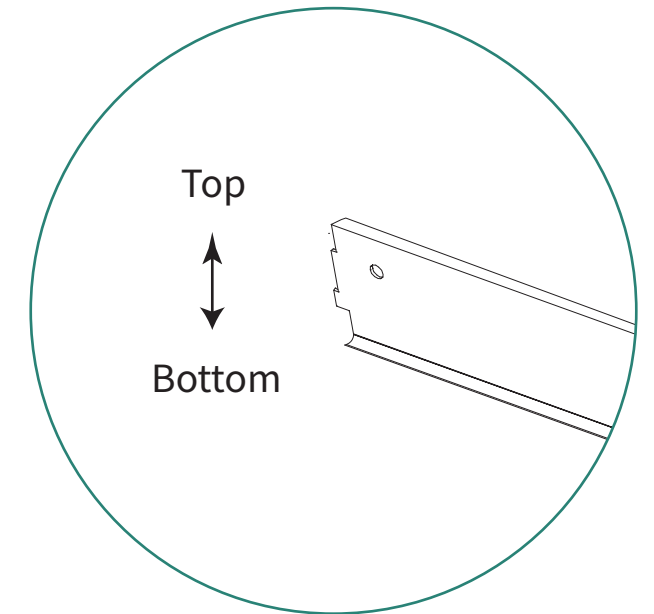

8

Lifting the hanging file bar slightly prior to removal makes removing or replacement easier.

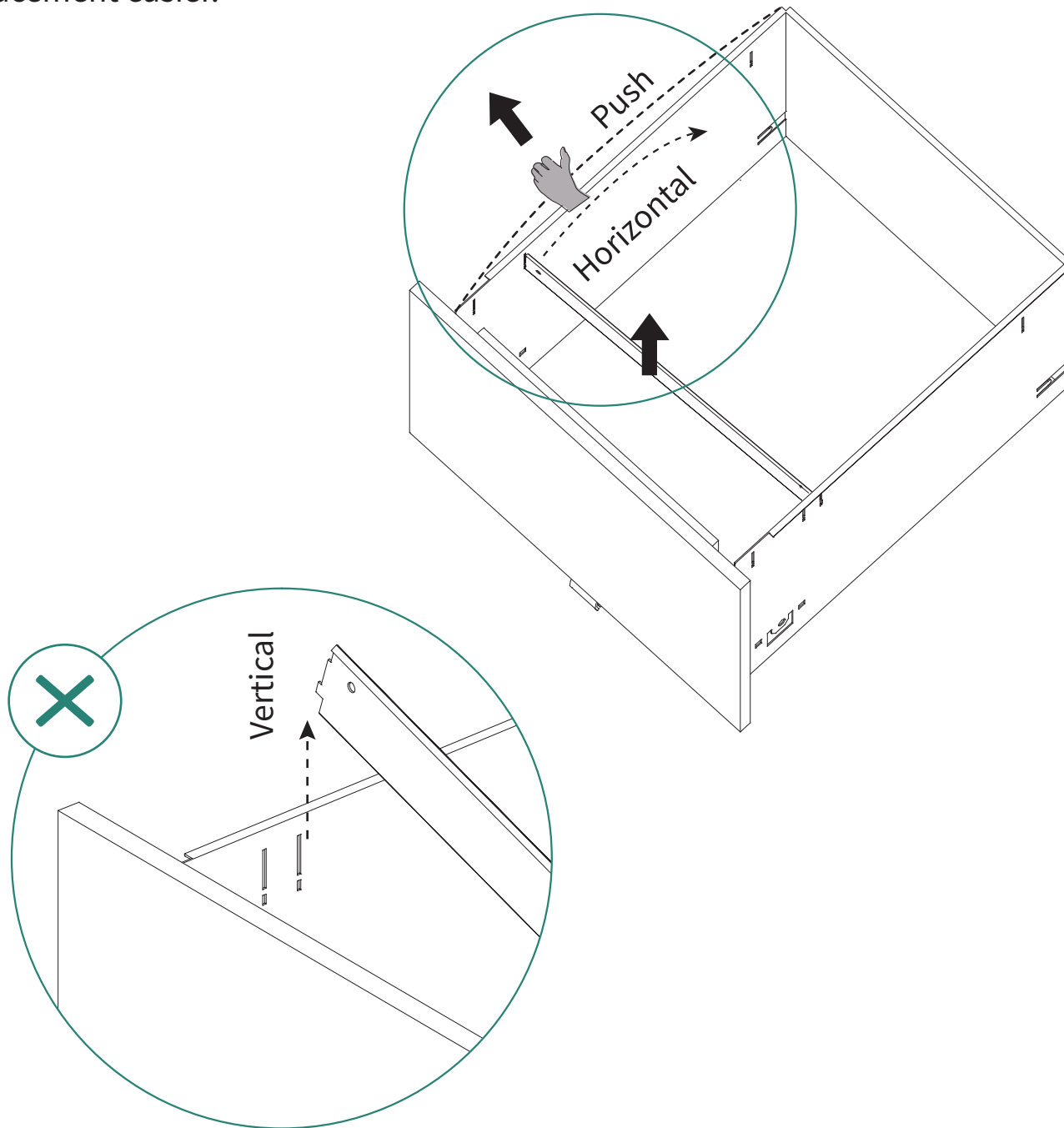

Instruction: 3 options available (Letter size , Legal size , A4 size)

Hanging file bar position 1 – for Letter size file folders.

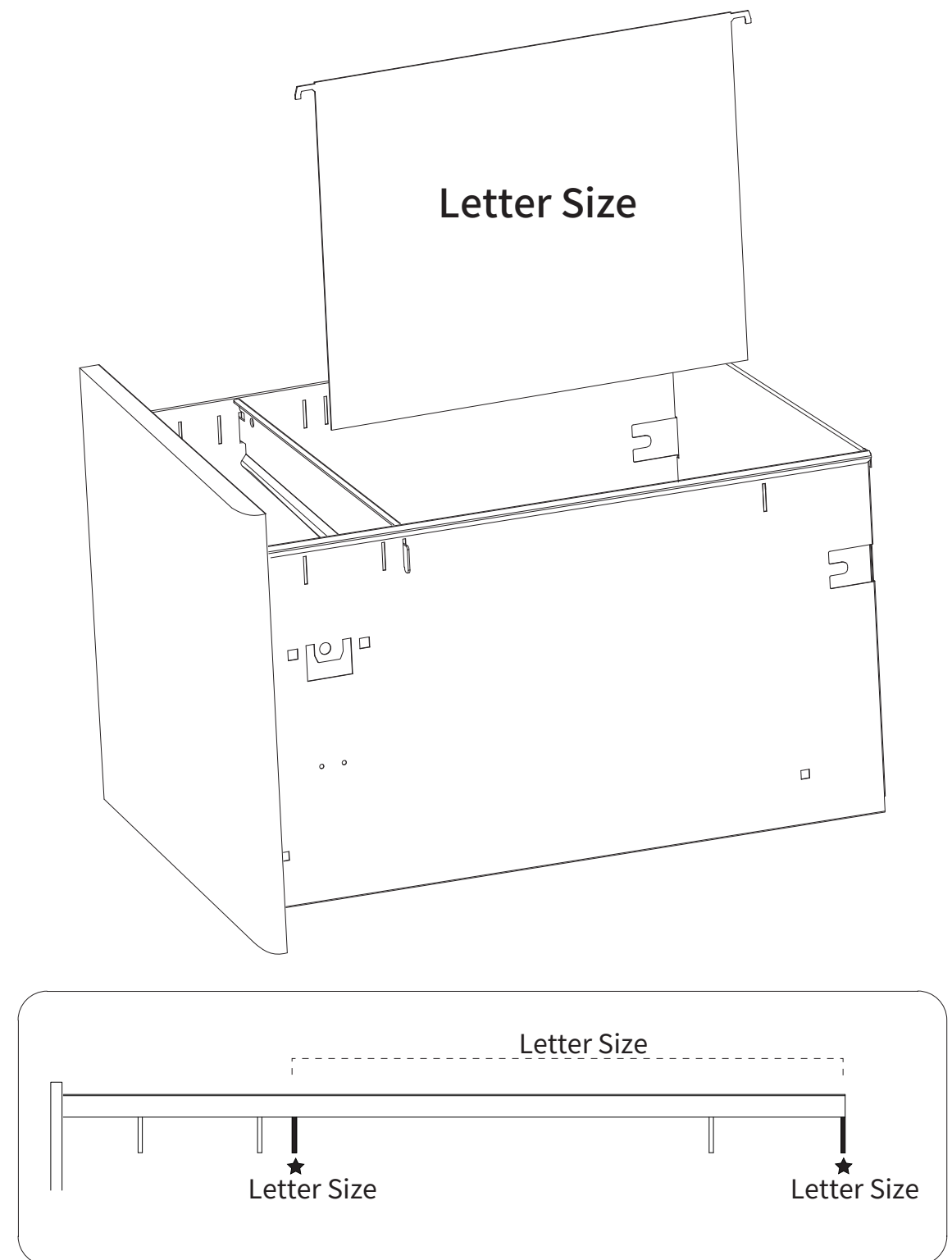

Hanging file bar position 2 – for A4 size file folders.

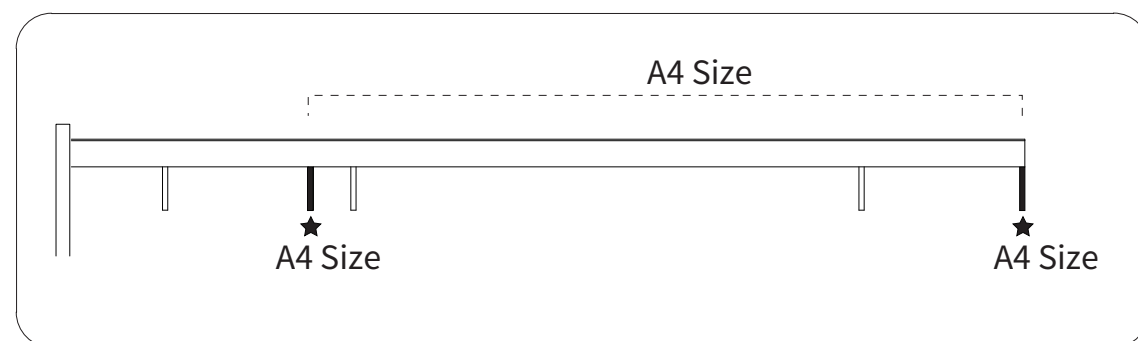
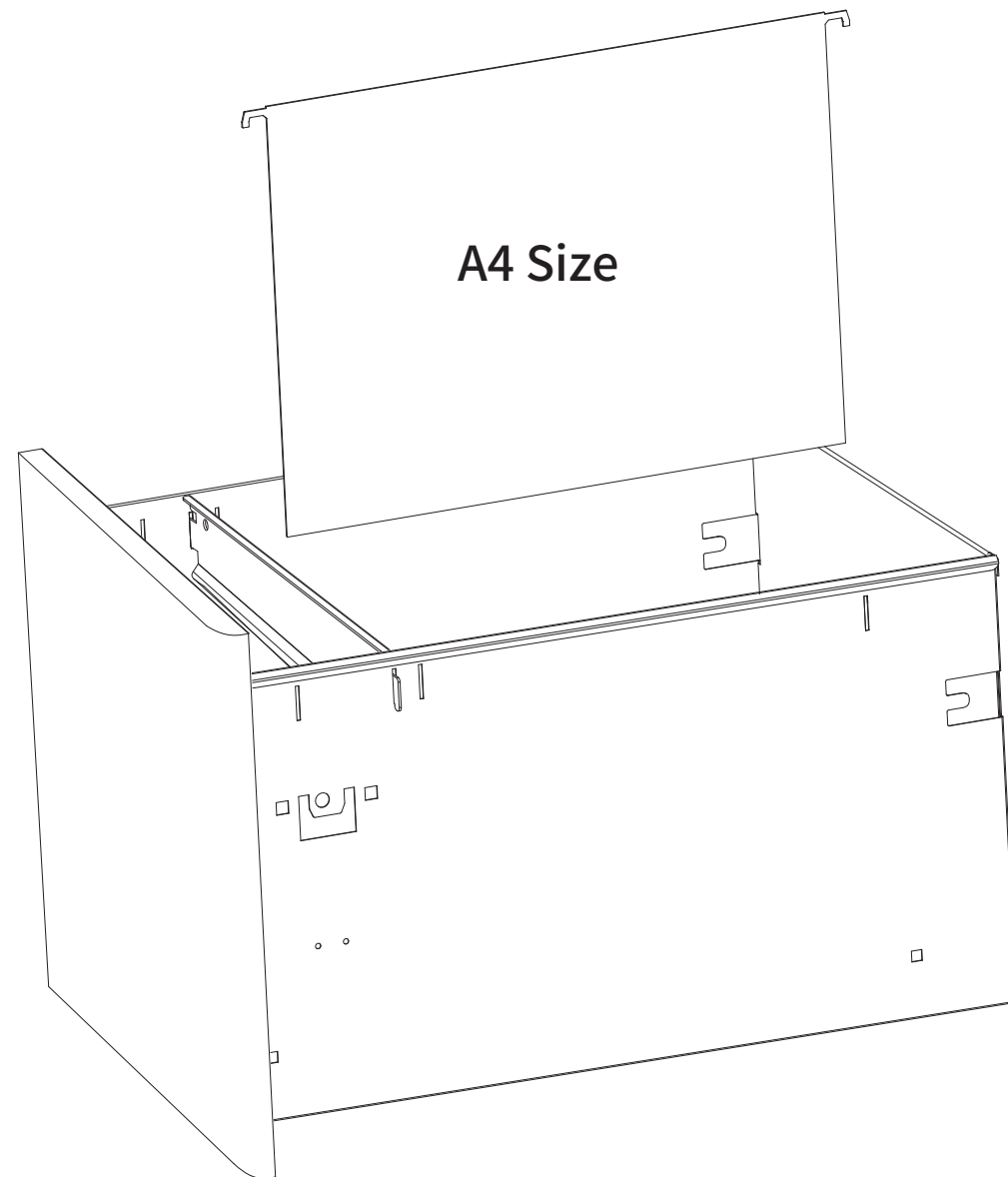

Hanging file bar position 3 – for Legal size file folders.

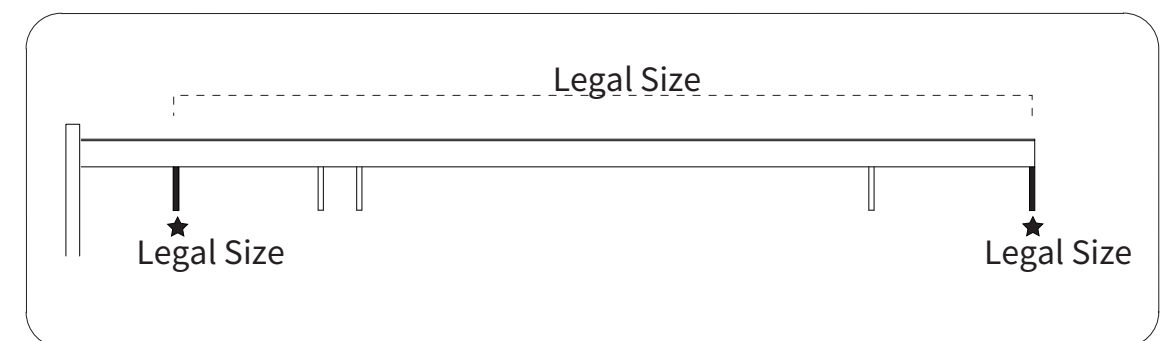
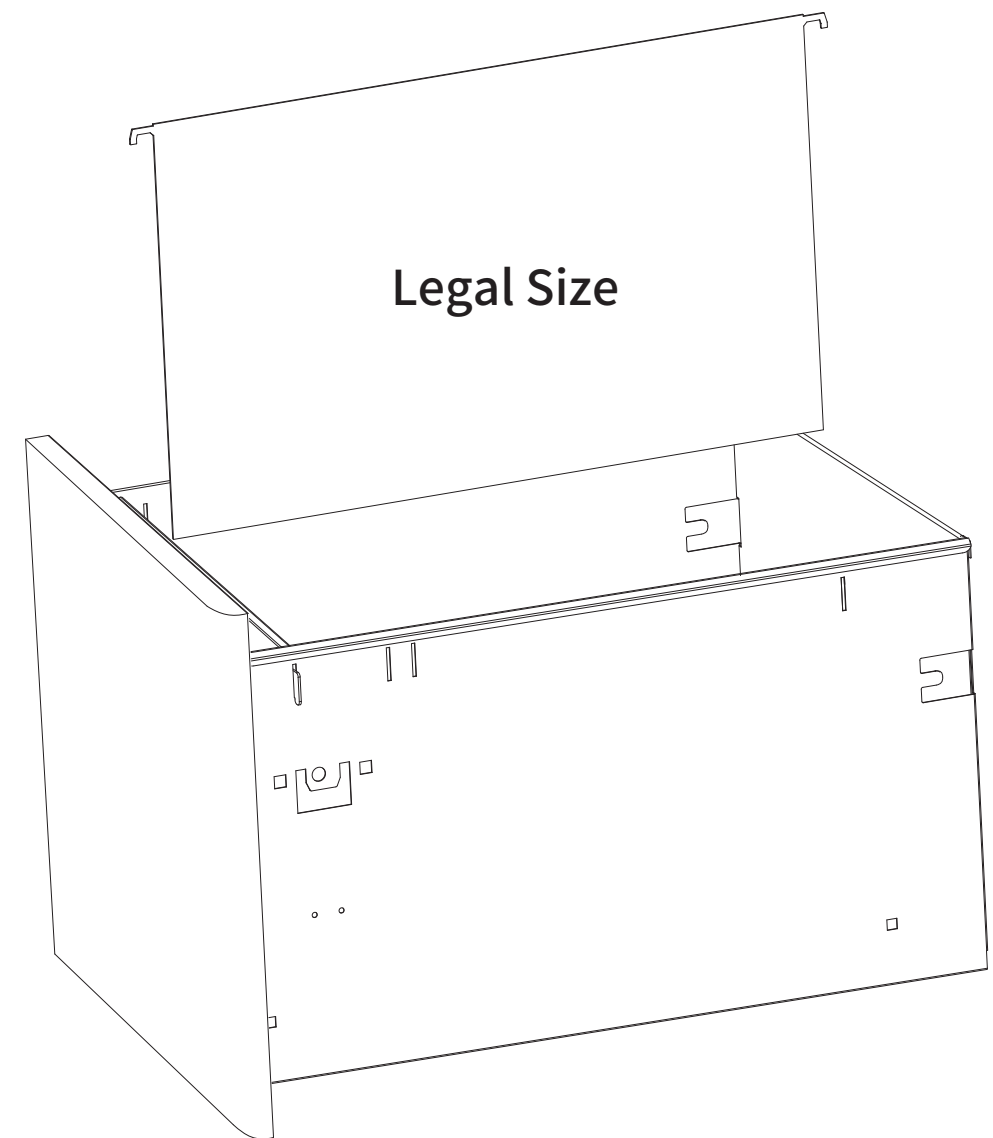

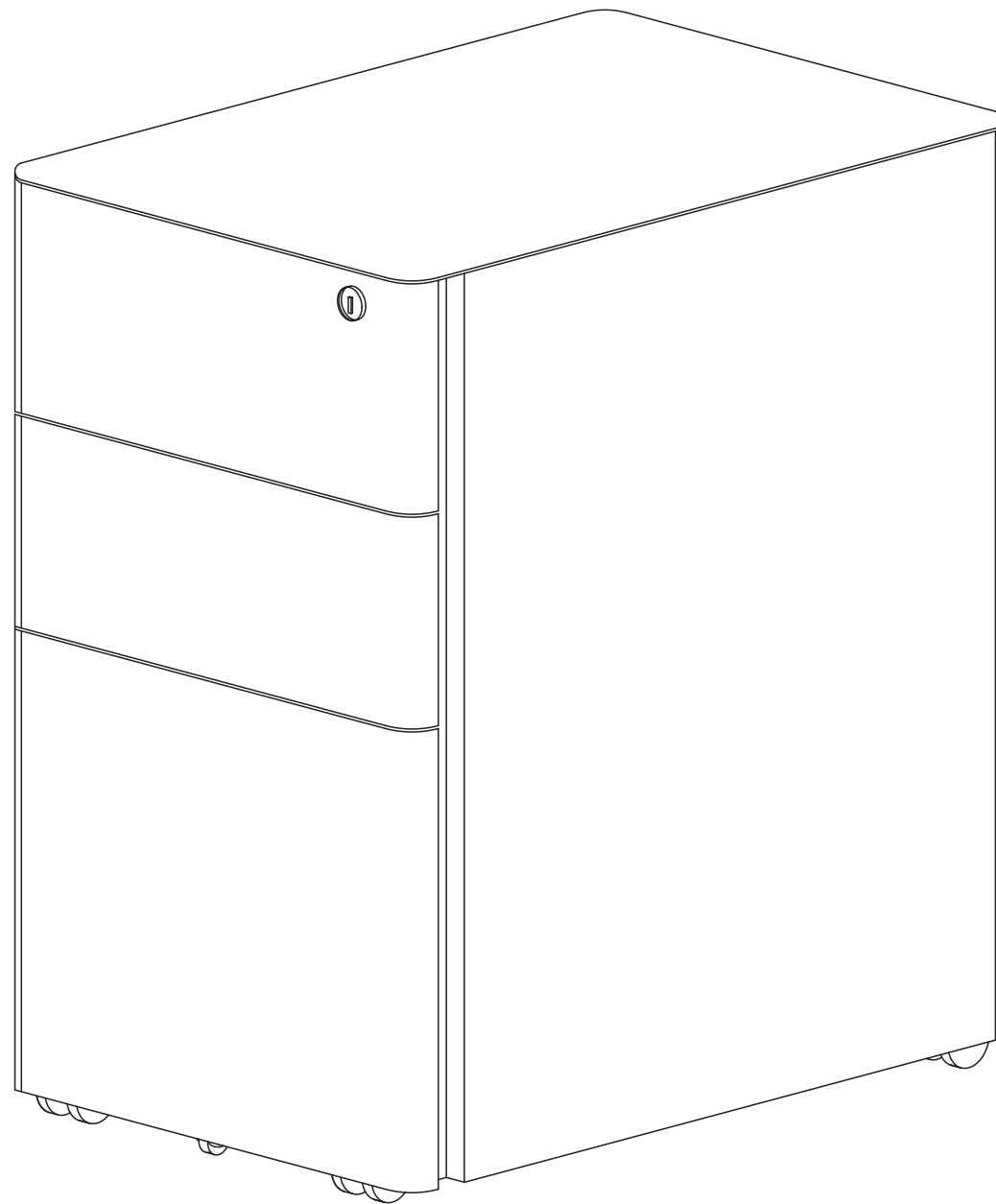

Installation Completed